

FACTS ABOUT DONG ENERGY'S BIOETHANOL PLANT

The bioethanol plant is developed by DONG Energy's technology company Inbicon A/S.

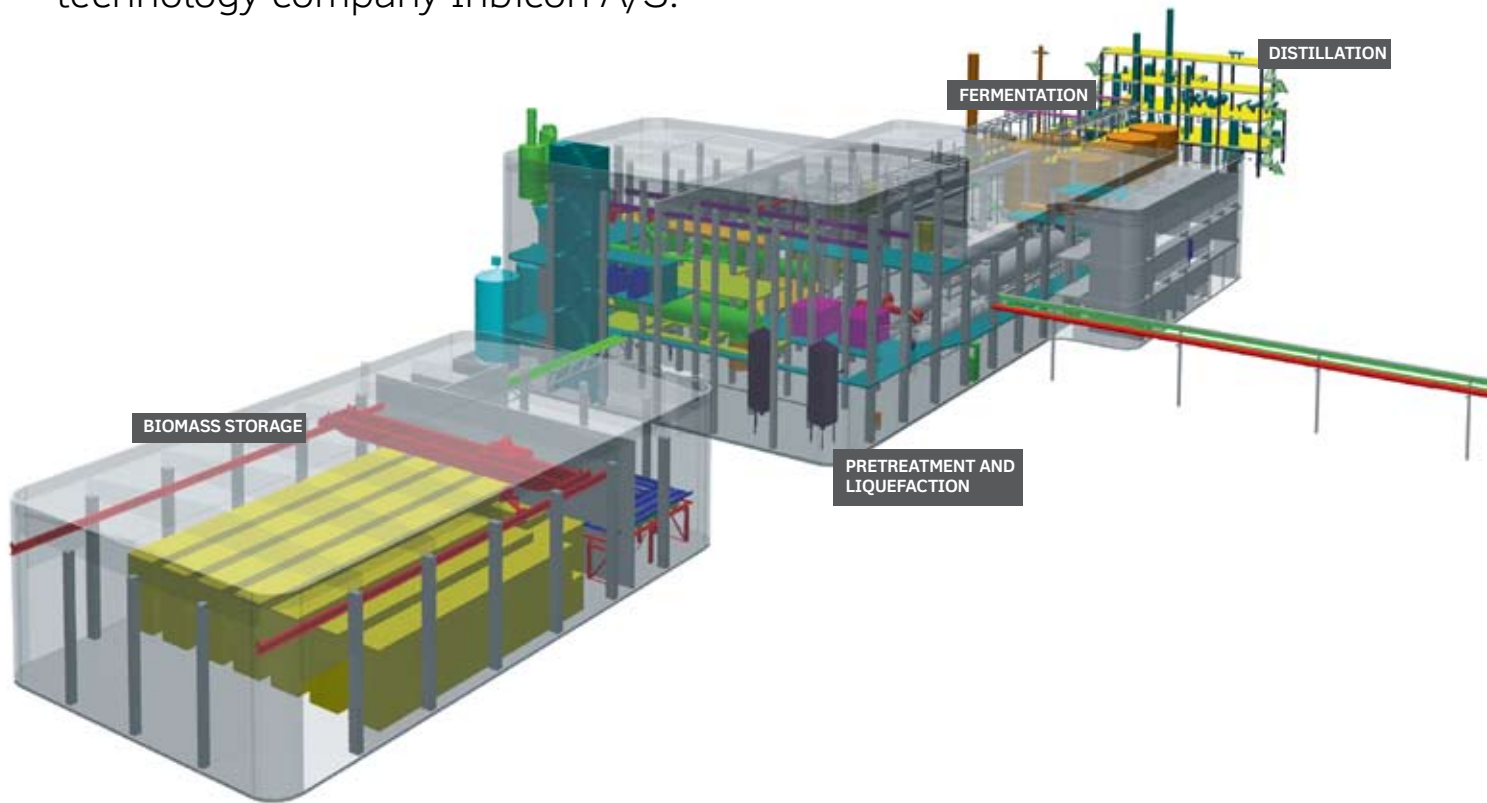

Raw materials

- 4 t/h equivalent to 30,000 tonnes of straw a year; supplied by farmers
- Enzymes supplied by Danisco Genecor and Novozymes

Annual production

- 5.4 million litres of bioethanol
- 13,000 tonnes of lignin pellets
- 11,100 tonnes C5 molasses

Employees

- 30 full-time employees

Costs

Total construction costs:

- About 400 million DKK (54 mio. EUR)

Grants

- Design and construction is supported by the Danish EUDP programme with 76.7 million DKK (10.3 mio. EUR)
- Demonstration is supported by the European Seventh Framework Programme with 67.7 million DKK (9.1 mio. EUR)



BIOETHANOL BASED ON 2ND GENERATION TECHNOLOGY

Inbicon's technology is so-called 2nd generation technology. The raw material base relies on residual products and not food crops from agriculture.

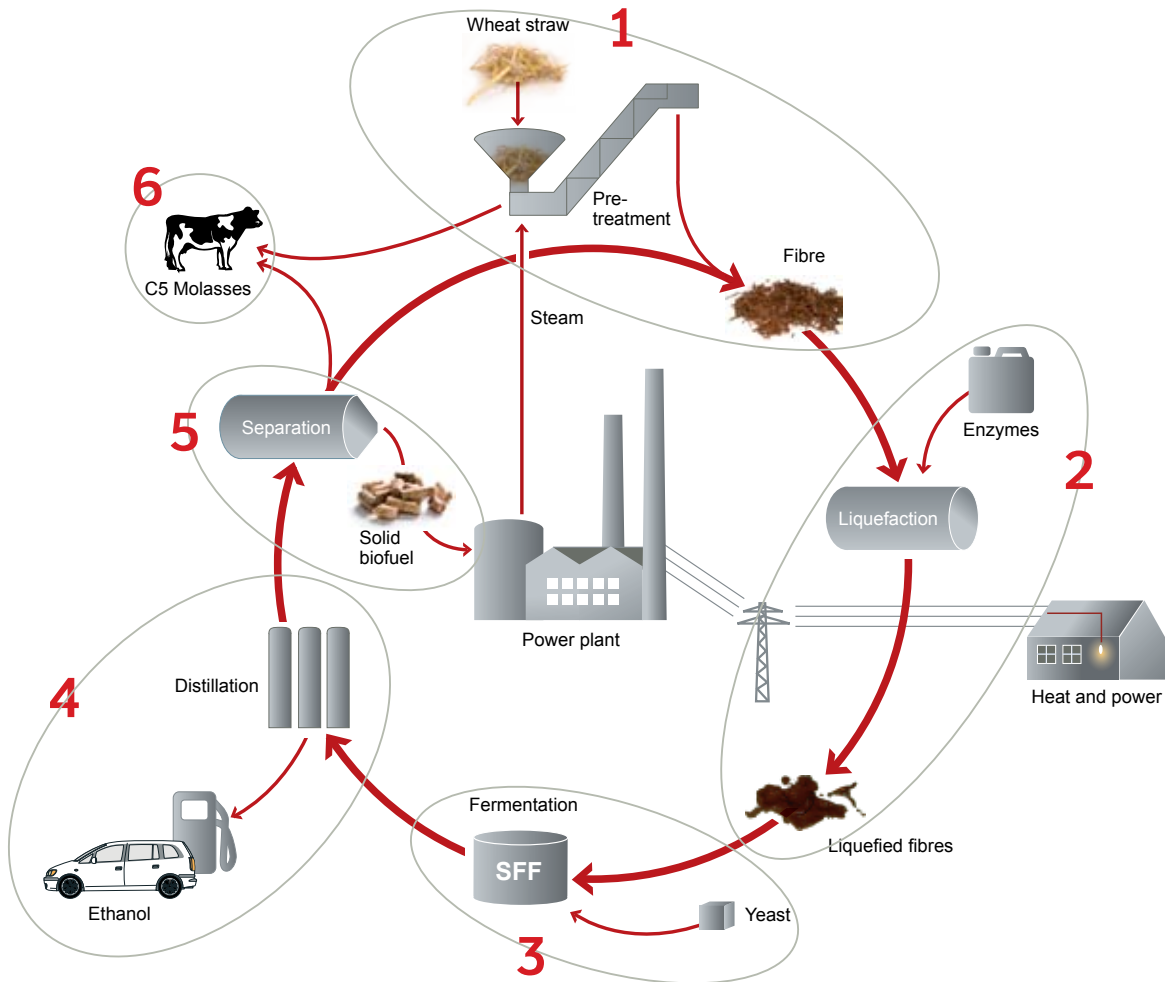

1. The straw is boiled at high temperatures and high pressure

2. Enzymes are added to convert the cellulose in the straw into sugar

3. The enzymes continue breaking down the cellulose into sugar, and the yeast converts the sugar into ethanol

4. The ethanol is evaporated, collected in its liquid state and can be used as car fuel

5. The remaining solids can be used as a CO₂ neutral fuel in power plants

6. The straw contains C5 sugar which is concentrated and can be used for animal food and other purposes

REDUCTION OF CO₂ EMISSIONS FROM THE TRANSPORT SECTOR

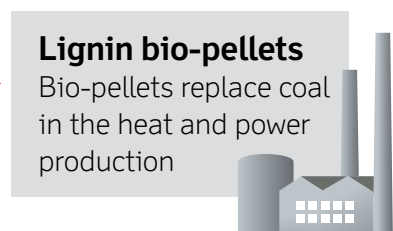
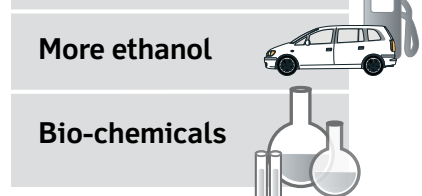
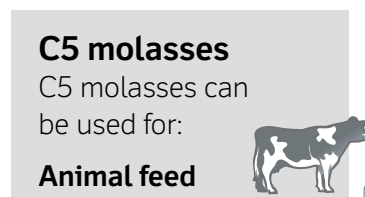
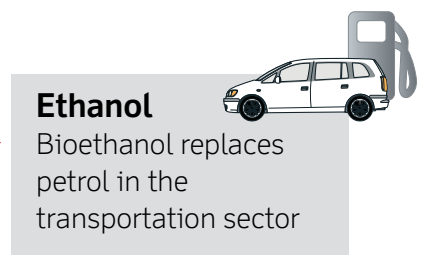
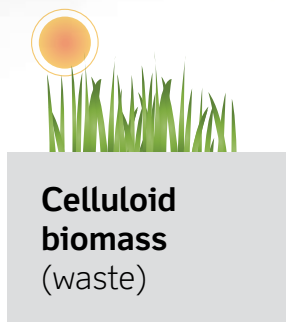

- Inbicon's bioethanol reduces the CO₂ emission by 84% compared to traditional fuel.
- If 10% of the petrol is replaced with Inbicon-bioethanol, the potential for CO₂ reduction in Denmark is 600,000 tonnes per year.
- If we include the production of bio-pellets and animal feed, an additional saving of 400,000 tonnes a year can be achieved.

DEMONSTRATION

Demonstration is critical for commercialization of the Inbicon technology.

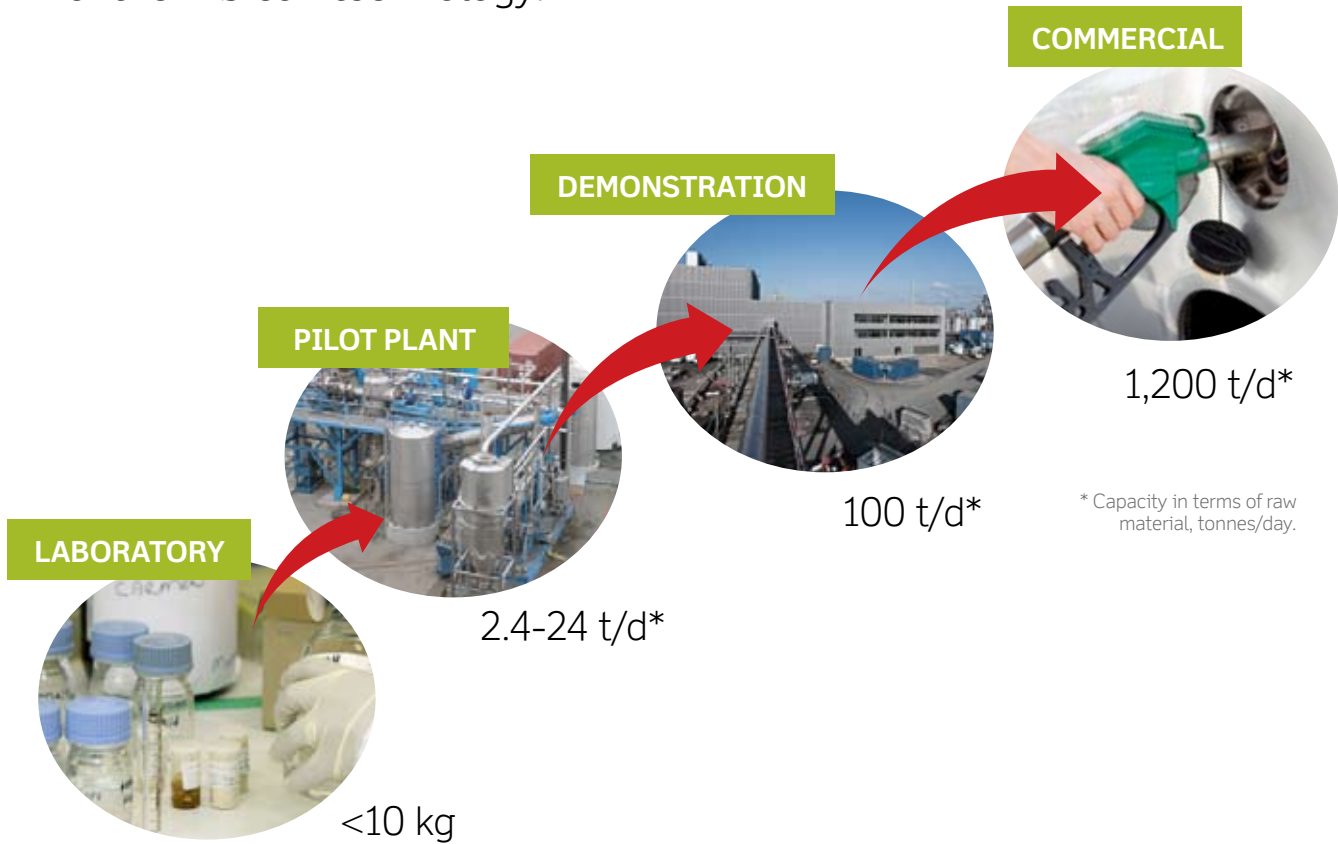

Gradual upscaling

Many creative solutions have been implemented in the process of taking the technology from idea to business.

Since 2002, DONG Energy has researched in and developed ways to utilize biomass in the transportation sector.

A key to success is the gradual upscaling in order to optimize solutions. Success in the lab is no guarantee for full scale-success.

Convincing the Customers

Once the demonstration plant proves the technology for handling and converting large quantities of biomass, customers from around the globe can have confidence in the technology.

New markets

As experts come together at the Inbicon Biomass Technology Campus™, new ideas and durable solutions will be created – giving Danish businesses an advantage and opening new markets for export.